

Barcode Reader BCR-POP1

1. Unpacking Check that all the provided items shown below are present.

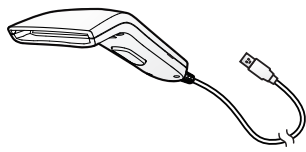

Barcode reader

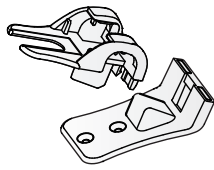

Barcode reader stand

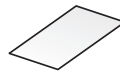

Double-sided tape



2 screws

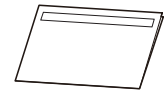

This manual

2. Installation

2-1. Connecting to the printer

Connect the USB connector of the barcode reader to one of the USB port of the printer (ether of the ports shown in the figure below).

< Example of connection >

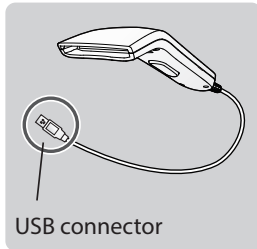

USB connector

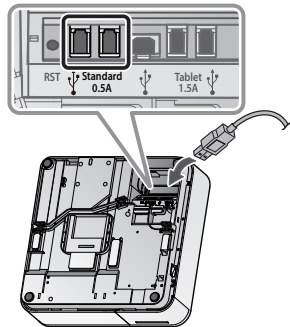

mPOP

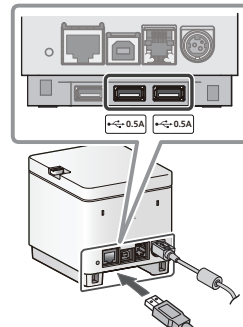

mC-Print2 (MCP21LB only)

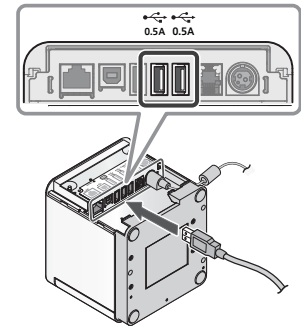

mC-Print3

2-2. Assembling and installing the barcode reader stand

Assemble the barcode reader stand as shown in the figure below [See Fig. 1]. As necessary, fasten with the provided double-sided tape or 2 screws [See Fig. 2]. Place the barcode reader in the stand [See Fig. 3].

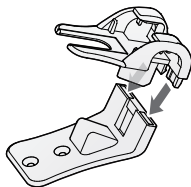

[Fig. 1]



[Fig. 2]

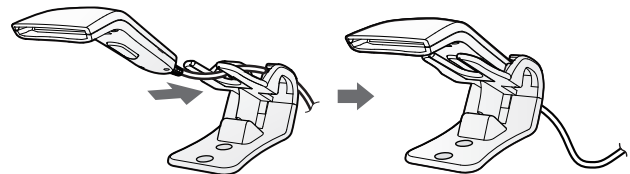

[Fig. 3]

3. Using the barcode reader

3-1. Turning on the printer power

Turn ON the power switch of the printer. When the printer is turned ON, power is supplied to the barcode reader and a melody sounds.

3-2. Reading barcodes

Face the barcode reading window towards the barcode and press the trigger switch. When the barcode is read, the LED lamp (blue) blinks once and a beep sound occurs.

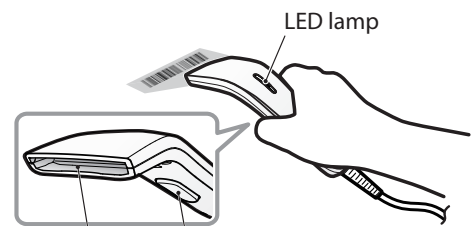

Reading window Trigger switch

◆ Online manual

For detailed operating procedures and USB cable connection methods, and other information, please refer to the online manual of the printer.

mPOP



www.star-m.jp/mpop-oml.html

mC-Print2



www.star-m.jp/mcprint2-oml.html

mC-Print3



www.star-m.jp/mcprint3-oml.html

◆ Downloading the mPOP Utility

When using an iOS/Android device, please use the special utility for the printer to change the barcode reader settings.

mPOP



www.star-m.jp/mpop-app.html

mC-Print2,3 series



www.star-m.jp/mcprint-app.html